

Safety Bulletin

SB No: 015

Rev: A

Date: August 14, 2006

Description: Elevator Horn Catch Hazard
Operational Alert



Tesco Corporation
6204 – 6A Street SE
Calgary, Alberta T2H 2B7
Phone: (403) 692-5700



www.tescocorp.com

TESCO

DISCUSSION

There has been a reported incident where, as the result of an error in Top Drive operation, the elevator horn(s) became caught in the torque track connector flange cavity. This can cause the lower end of the tubular held by the elevator to move with uncontrolled and unpredictable motion. This presents an equipment and personnel injury hazard when **all of the following listed conditions exist**.

List of Conditions,

1. Tubular product latched in elevator and
2. Elevator horns facing the torque track and
3. Elevator links are link tilted towards or swing into, the torque track flange cavity during the raising/lowering of the tubular.

See Figure 1 to illustrate this condition.

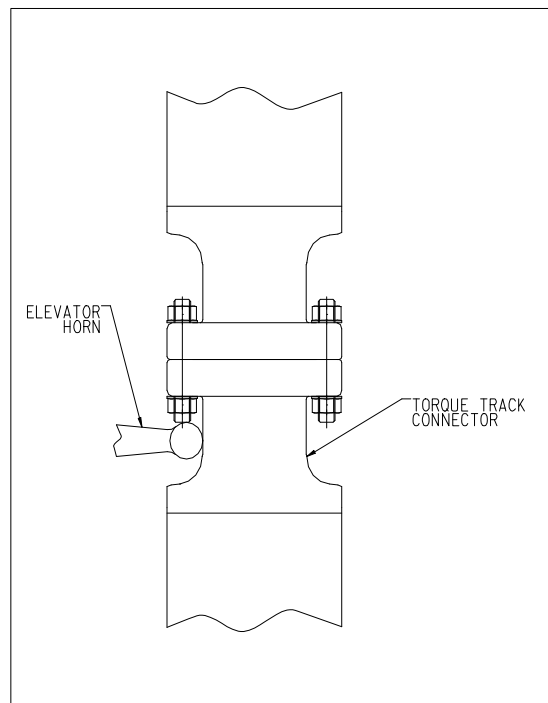

Figure 1.

Operations Affected

Any operation where the elevator horns are positioned facing towards the torque track.

Torque Track Types Affected

All Tesco Top Drive Systems with bolted torque track connector flanges have the potential to be affected by this bulletin.

ACTIONS REQUIRED

If you operate or there is the potential of operating your Top Drive System under the conditions indicated above, at minimum the following points shall be addressed with all appropriate personnel before work is allowed to proceed.

1. The contents of this bulletin are to be presented and understood by appropriate Drilling Personnel,
2. Due care and attention is to be applied when the elevator is in close proximity to the torque track, especially during raising/lowering operations as noted in the "List of Conditions".

If you require more detail specific to an operation presented in the Tesco manuals or a specific operation you maintain, please contact your Tesco Representative or e-mail Tesco Bulletin Administrator, address below.

Please contact Tesco Corporation at the following email address on issues specific to this bulletin.

Safety_Technical_Bulletins@TescoCorp.com