



Model: Sigma

Serial #: N/A

Mar. 7, 2025

Product Bulletin # TDS-263 Rev 1

Sigma Top Drive Brake Obsolescence

The production of the Sigma brake assembly (P/N: M17138) has been discontinued by the OEM manufacturer. A replacement brake is available which offers improved functionality.

Affected Models

Sigma Top Drives

New Brake Improvements

- Single-piece cylinder plate
- Improved disc brake disengagement

Obsolete Brake Assembly	New Brake Assembly
M17138	M15601

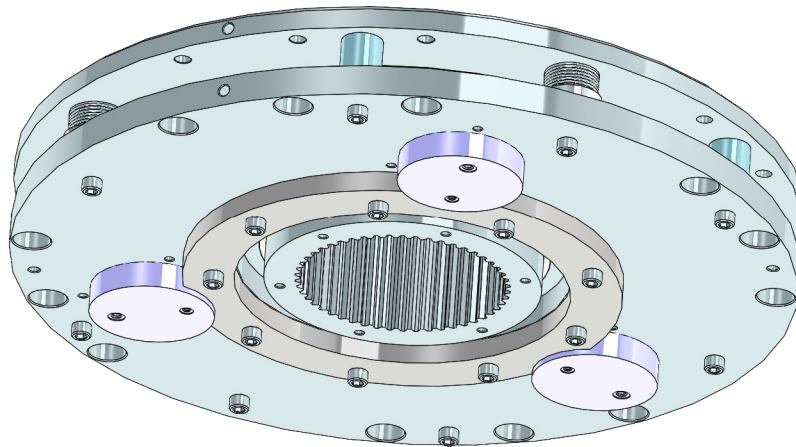

Figure 1: M17138 / Obsolete Brake Assembly



Model: Sigma Serial #: N/A	Mar. 7, 2025
-------------------------------	--------------

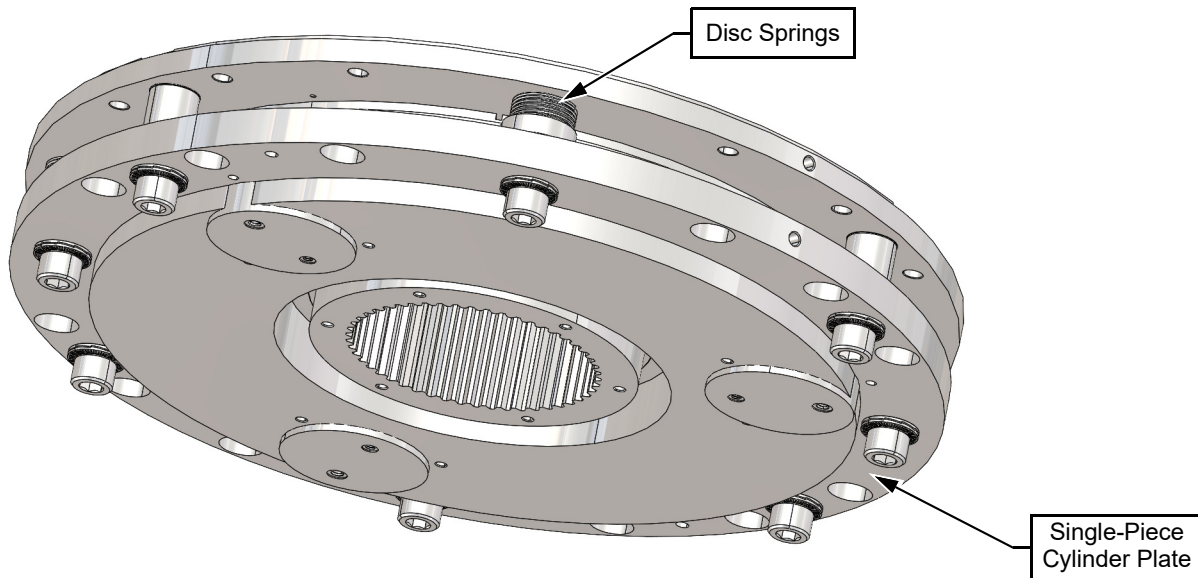

Figure 2: M15601 / New Brake Assembly

Recommendation

Canrig recommends that customers upgrade their brake assembly at the next scheduled top drive recertification.

Continue to monitor brake performance and follow the recommended maintenance schedule.